

**FLOOR PLAN
PAVILION - CLUSTER A**

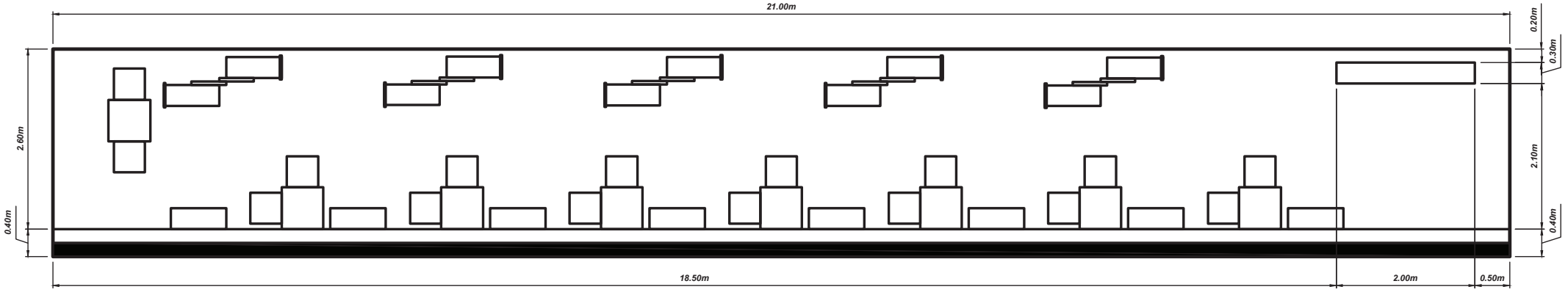

FLOORING SHEDULE

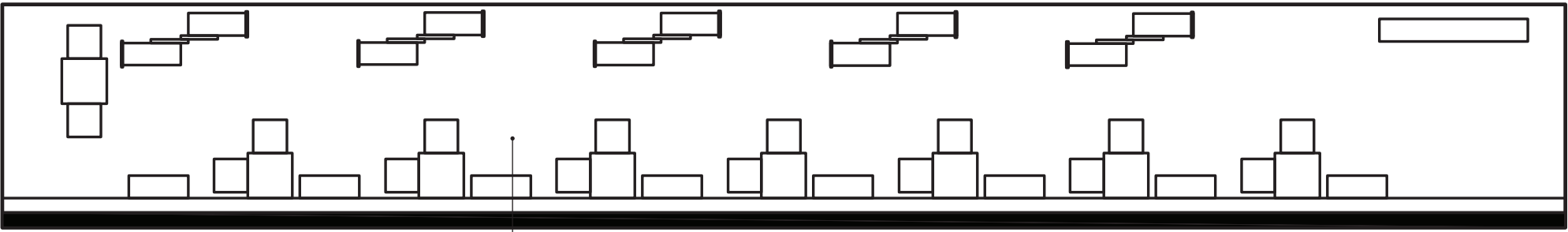

**WOODEN FLOORING
IN FINE WOOD FINISH
(21.00m x 3.00m)**

	PROJECT:	GULFOOD 2022	CONTENT:	DETAILS	
	TITLE:	PHILIPPINE PAVILION	DESIGNER:	MIR	
DATE:	01/07/2022	REVISION:	01	LOCATION:	DUBAI WORLD TRADE CENTER
			SHEET NO.:	4	

CLUSTER A - STRUCTURE

ELEVATION VIEW

NOTE: PRODUCT DISPLAY AND GONDOLA ARE NOT SHOWN FOR CLARITY

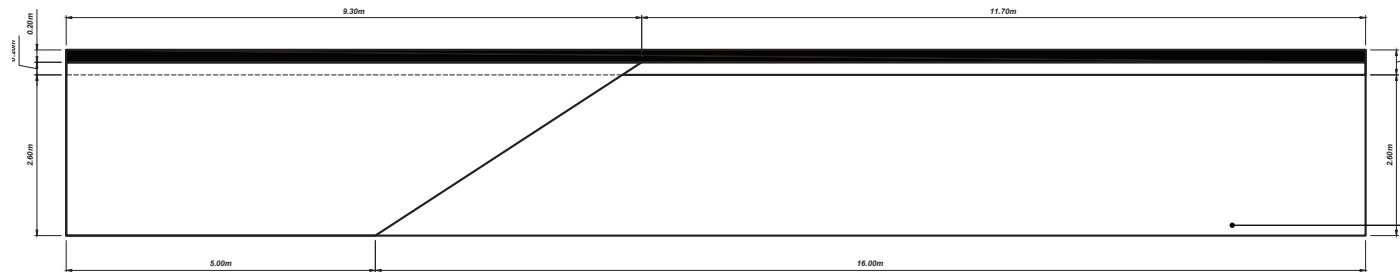

**WOODEN FLOORING
IN FINE WOOD FINISH**
(21.00m x 3.00m)

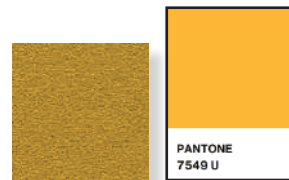

WOODEN STURCTURE
3/4" Plywood in 2" x 2" KD
framing painted in **Pantone**
7549U Solid Uncoated in
EGGSHELL texture

LETTER CUT-OUT
Lighted PVC cut-out
7.00m x 1.20m x 4" THK

TYPICAL DETAIL
ON PAGE 07

TYPICAL DETAIL
ON PAGE 08

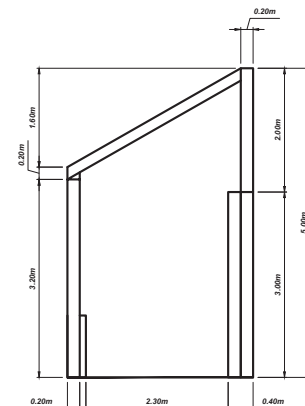
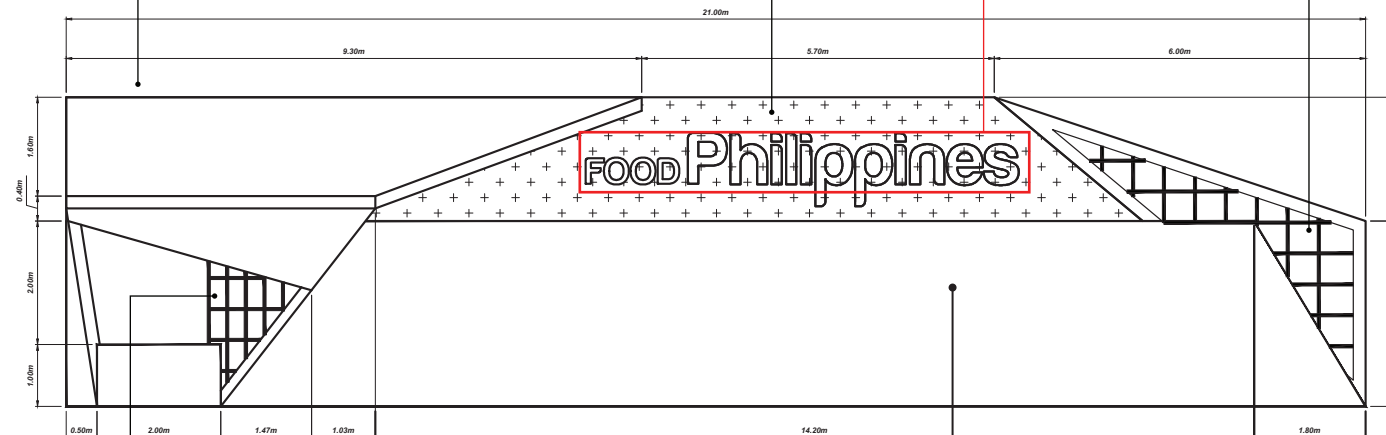
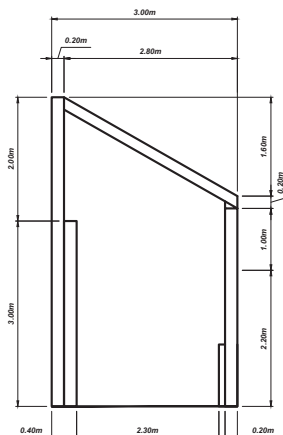

TYPICAL DETAIL
ON PAGE 09



WOODEN STURCTURE
3/4" Plywood in 2" x 2" KD
framing painted in **Pantone**
5757U Solid Uncoated in
EGGSHELL texture

	PROJECT:	GULFOOD 2022	CONTENT:	DETAILS	
	TITLE:	PHILIPPINE PAVILION	DESIGNER:	MIR	
DATE:	01/07/2022	REVISION:	01	LOCATION:	DUBAI WORLD TRADE CENTER
			SHEET NO.:	6	

CLUSTER A - STRUCTURE

ELEVATION VIEW

NOTE: OVERHANG, PRODUCT DISPLAY AND GONDOLA ARE NOT SHOWN FOR CLARITY

BACKLIT Wall Panel

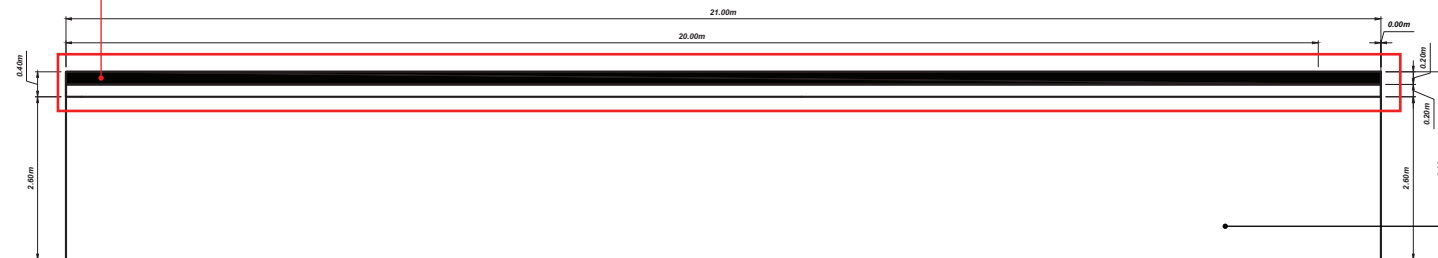

WOODEN FLOORING
IN FINE WOOD FINISH
(21.00m x 3.00m)

WOODEN STURCTURE
3/4" Plywood in 2" x 2" KD
framing painted in **Pantone**
7549U Solid Uncoated in
EGGSHELL texture

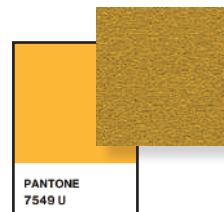

LETTER CUT-OUT
Lighted PVC cut-out
7.00m x 1.20m x 4" THK

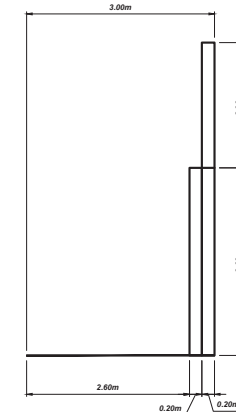
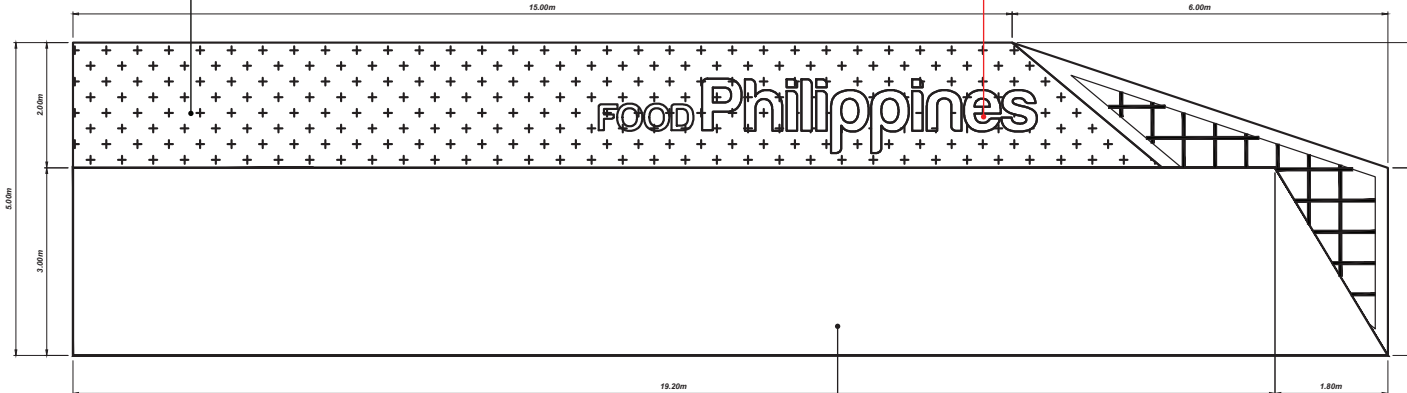
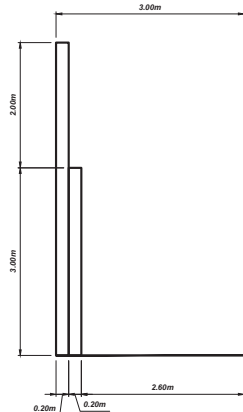

WOODEN STURCTURE
3/4" Plywood in 2" x 2" KD
framing painted in **Pantone**
5757U Solid Uncoated in
EGGSHELL texture



	PROJECT:	GULFOOD 2022	CONTENT:	DETAILS	
	TITLE:	PHILIPPINE PAVILION	DESIGNER:	MIR	
DATE:	01/07/2022	REVISION:	01	LOCATION:	DUBAI WORLD TRADE CENTER
			SHEET NO.:	7	

OVERHANG STRUCTURE

ELEVATION VIEW

NOTE: PRODUCT DISPLAY AND GONDOLA ARE NOT SHOWN FOR CLARITY

TYPICAL DIMENSION



Painted in Pantone 5757U Solid Uncoated



OVERHEAD CEILING in Fine Wood Finish



WOODEN STURCTURE
3/4" Plywood in 2" x 2" KD framing painted in Pantone 5757U Solid Uncoated in EGGSHELL texture



OVERHEAD CEILING in Fine Wood Finish

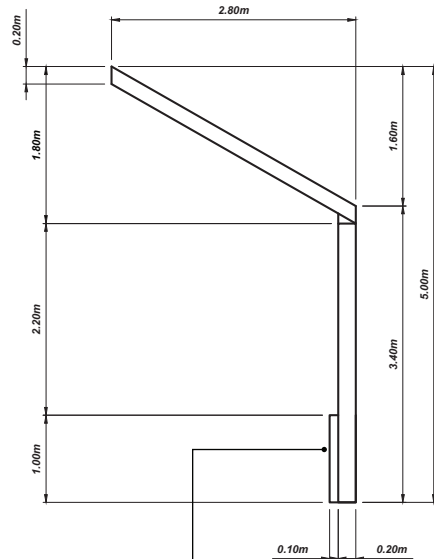
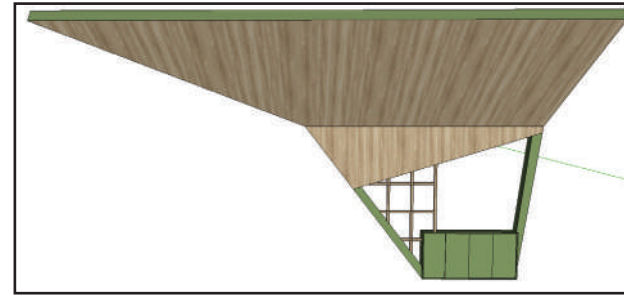
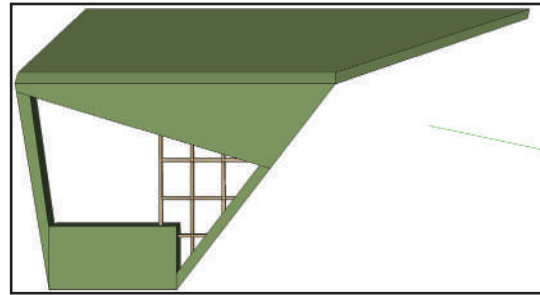

RECEPTION COUNTER WITH LOCKABLE CABINET

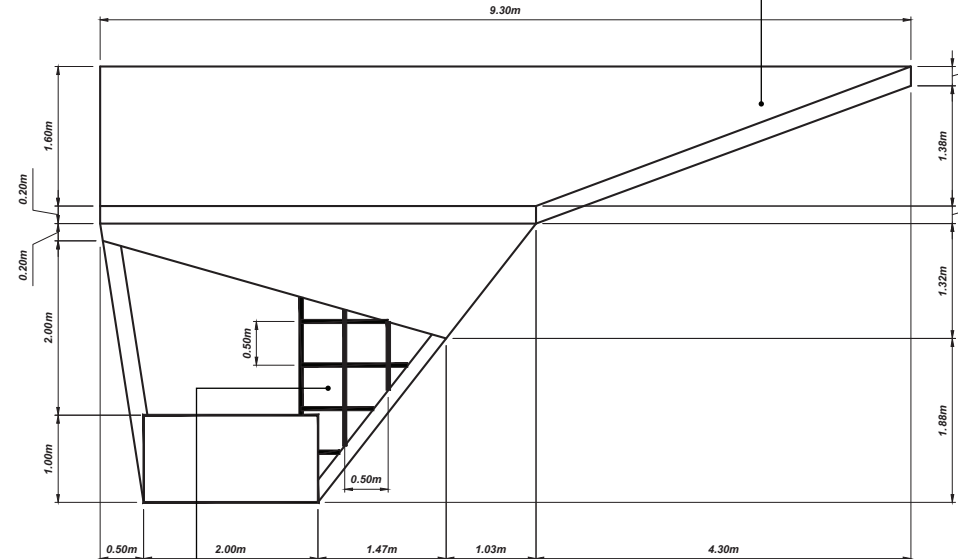

2" x 2" KD framing in NATURAL wood Finish
Typical spacing @ 0.50m

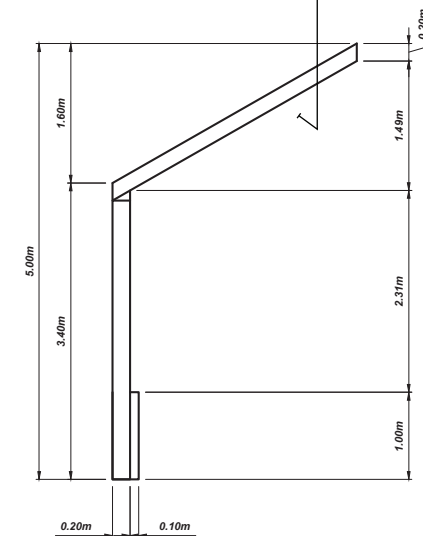

TYPICAL DIMENSION FOR OVERHANG

	PROJECT:	GULFOOD 2022	CONTENT:	DETAILS	
	TITLE:	PHILIPPINE PAVILION	DESIGNER:	MIR	
DATE:	01/07/2022	REVISION:	01	LOCATION:	DUBAI WORLD TRADE CENTER
			SHEET NO.:	8	

WALL ACCENT

ELEVATION VIEW

NOTE: PRODUCT DISPLAY AND GONDOLA ARE NOT SHOWN FOR CLARITY

TYPICAL DIMENSION

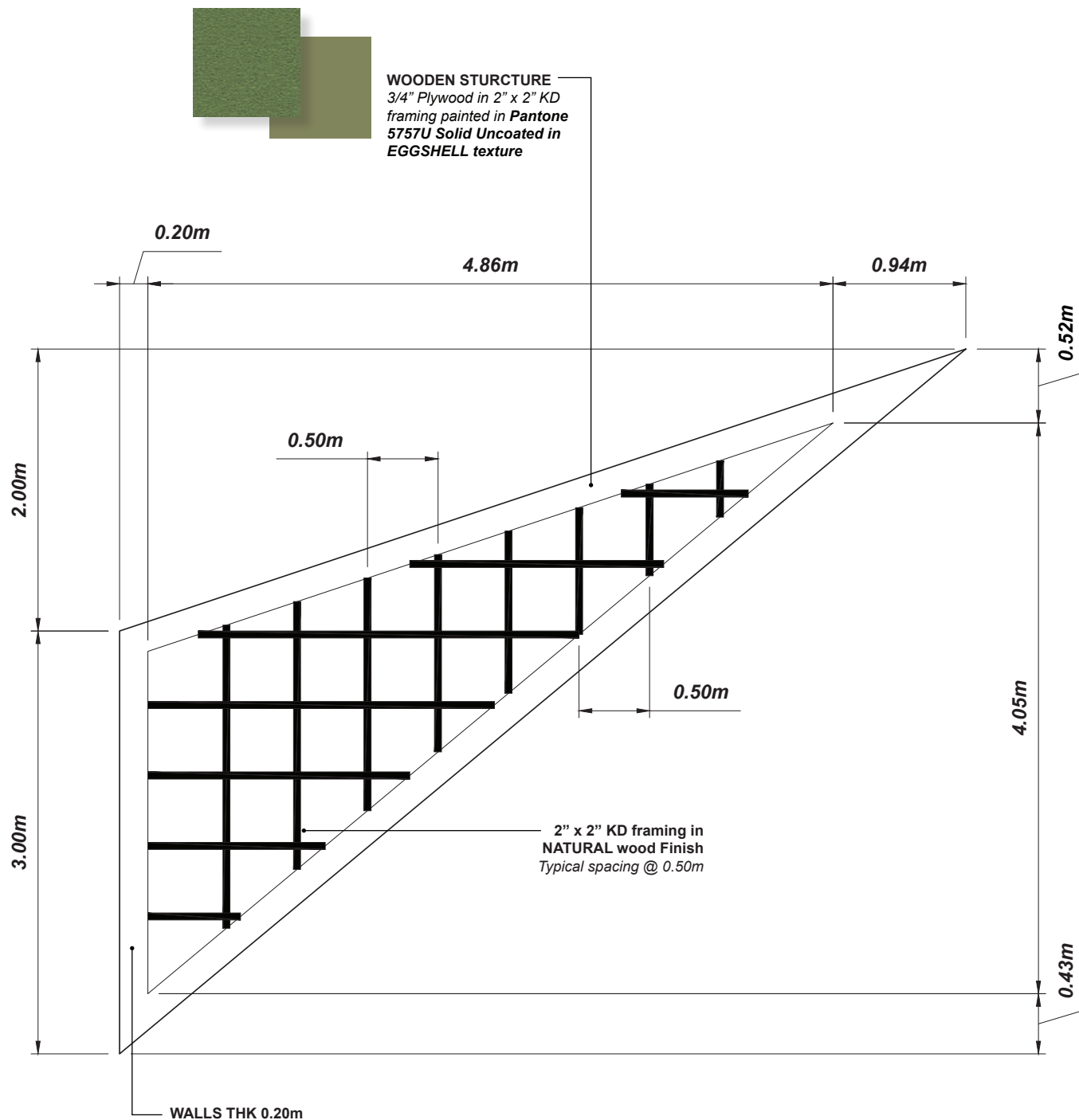

	PROJECT:	GULFOOD 2022	CONTENT:	DETAILS	
	TITLE:	PHILIPPINE PAVILION	DESIGNER:	MIR	
DATE:	01/07/2022	REVISION:	01	LOCATION:	DUBAI WORLD TRADE CENTER
			SHEET NO.:	9	

**FLOOR PLAN
PAVILION - CLUSTER B**

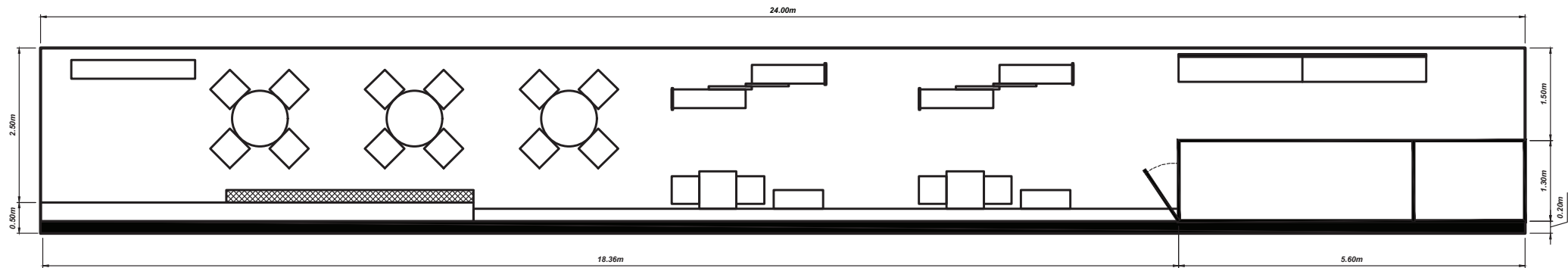

FLOORING SHEDULE

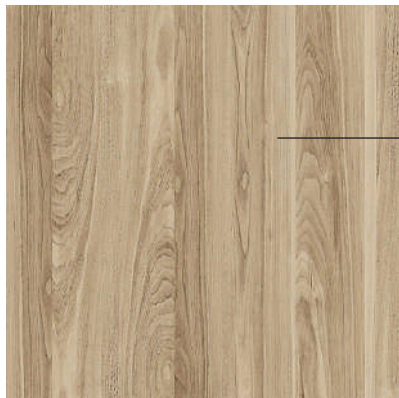
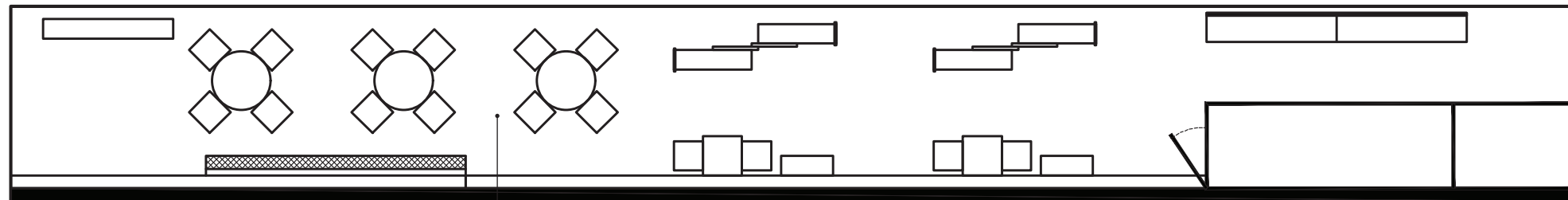

**WOODEN FLOORING
IN FINE WOOD FINISH
(24.00m x 3.00m)**

	PROJECT:	GULFOOD 2022	CONTENT:	DETAILS	
	TITLE:	PHILIPPINE PAVILION	DESIGNER:	MIR	
DATE:	01/07/2022	REVISION:	01	LOCATION:	DUBAI WORLD TRADE CENTER
			SHEET NO.:	10	

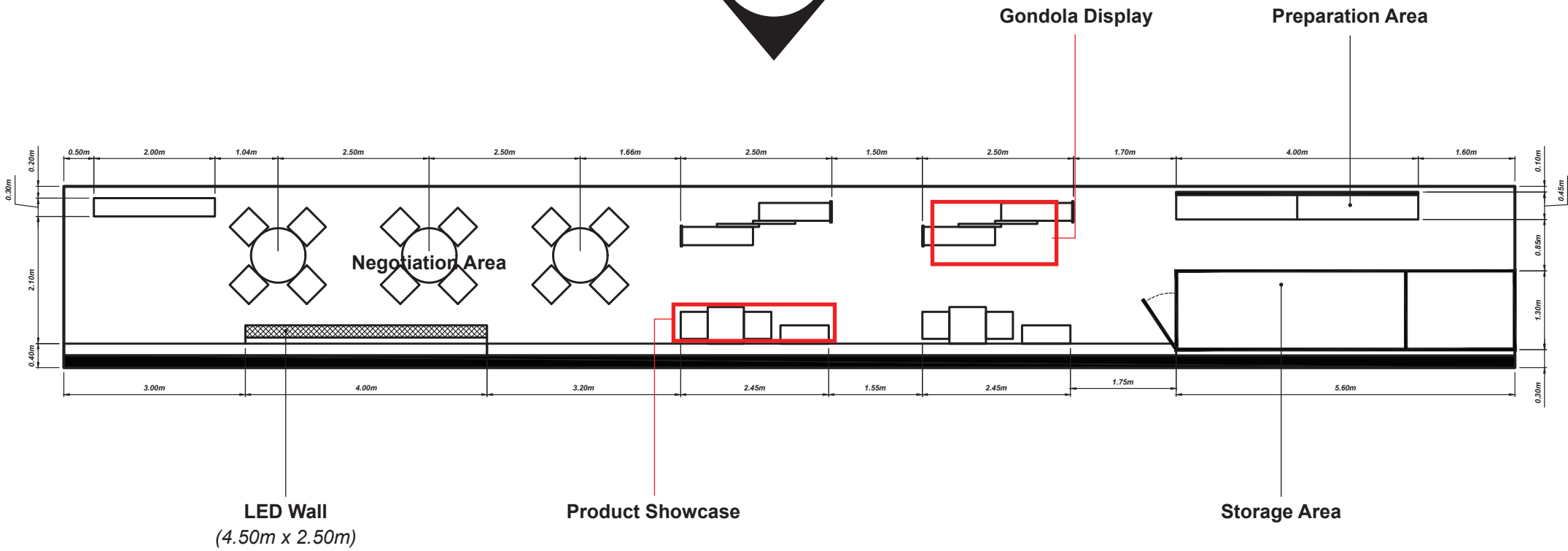

	PROJECT:	GULFOOD 2022	CONTENT:	DETAILS	
	TITLE:	PHILIPPINE PAVILION	DESIGNER:	MIR	
DATE:	01/07/2022	REVISION:	01	LOCATION:	DUBAI WORLD TRADE CENTER
			SHEET NO.:	11	

CLUSTER B - STRUCTURE

ELEVATION VIEW

NOTE: PRODUCT DISPLAY AND GONDOLA ARE NOT SHOWN FOR CLARITY

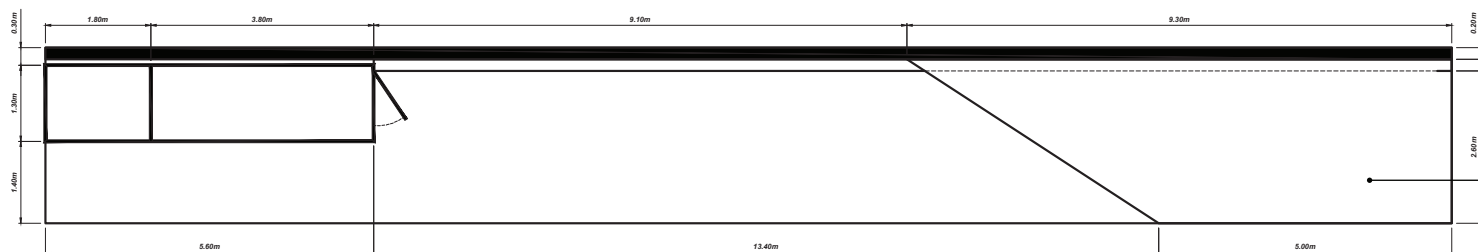

**WOODEN FLOORING
IN FINE WOOD FINISH**
(21.00m x 3.00m)

TYPICAL DETAIL
ON PAGE 09

LETTER CUT-OUT
Lighted PVC cut-out
6.70m x 1.15m x 4" THK

WOODEN STURCTURE
3/4" Plywood in 2" x 2" KD
framing painted in **Pantone
5757U Solid Uncoated** in
EGGSHELL Texture

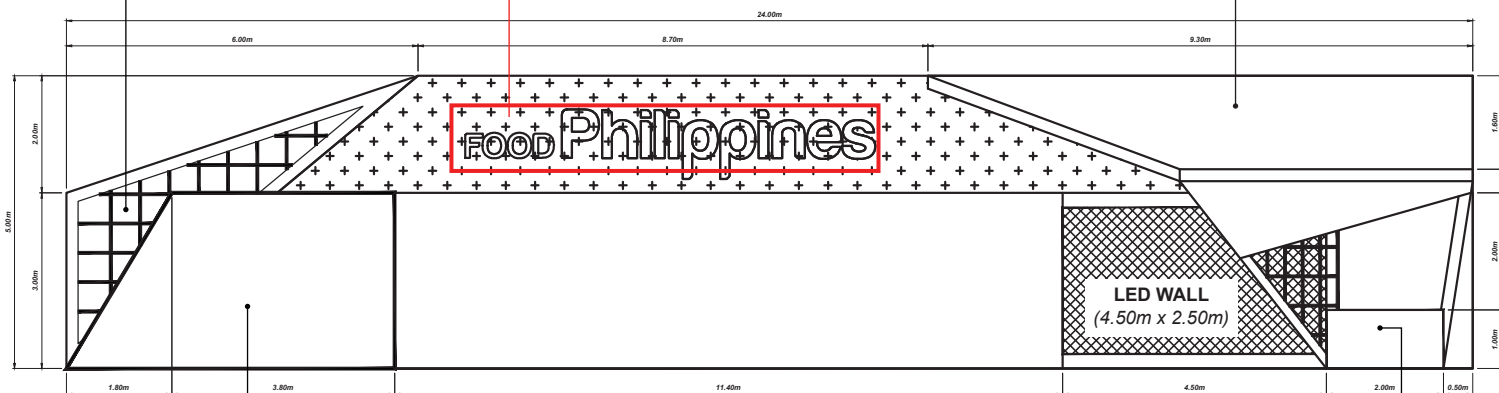
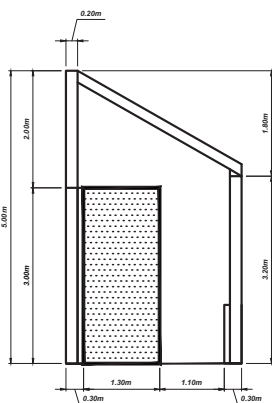

TYPICAL DETAIL
ON PAGE 15

TYPICAL DETAIL
ON PAGE 08

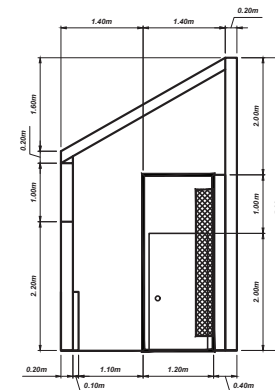

	PROJECT:	GULFOOD 2022	CONTENT:	DETAILS	
	TITLE:	PHILIPPINE PAVILION	DESIGNER:	MIR	
DATE:	01/07/2022	REVISION:	01	LOCATION:	DUBAI WORLD TRADE CENTER
			SHEET NO.:	12	

CLUSTER B - STRUCTURE ELEVATION VIEW

NOTE: OVERHANG, PRODUCT DISPLAY AND GONDOLA ARE NOT SHOWN FOR CLARITY

BACKLIT Wall Panel

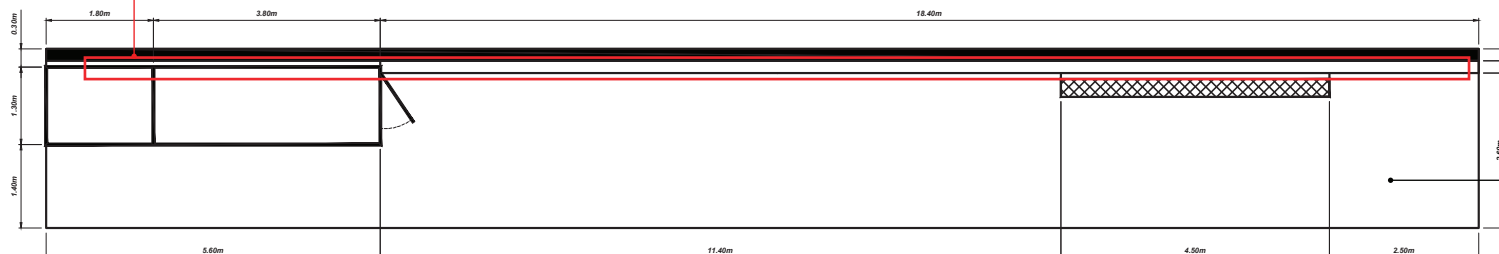

WOODEN FLOORING
IN FINE WOOD FINISH
(24.00m x 3.00m)

LETTER CUT-OUT
Lighted PVC cut-out
6.70m x 1.15m x 4" THK

WOODEN STURCTURE
3/4" Plywood in 2" x 2" KD
framing painted in Pantone
7549 U Solid Uncoated in
EGGSHELL Texture

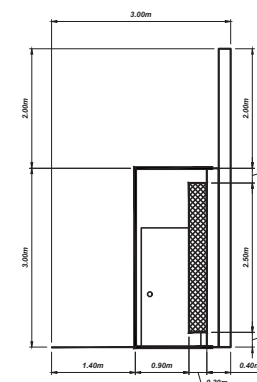
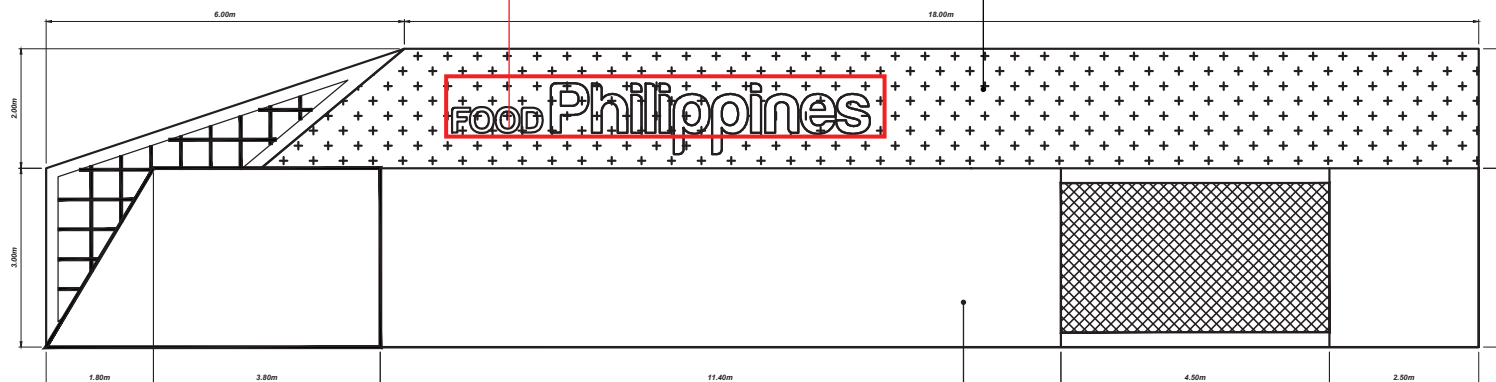
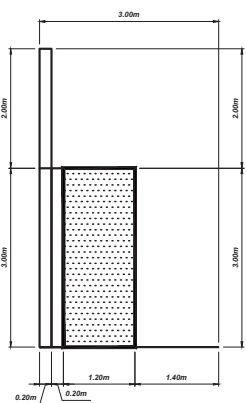

WOODEN STURCTURE
3/4" Plywood in 2" x 2" KD
framing painted in Pantone
5757U Solid Uncoated in
EGGSHELL Texture



	PROJECT:	GULFOOD 2022	CONTENT:	DETAILS	
	TITLE:	PHILIPPINE PAVILION	DESIGNER:	MIR	
DATE:	01/07/2022	REVISION:	01	LOCATION:	DUBAI WORLD TRADE CENTER
			SHEET NO.:	13	

GONDOLA DISPLAY (CLUSTER A) ELEVATION VIEW

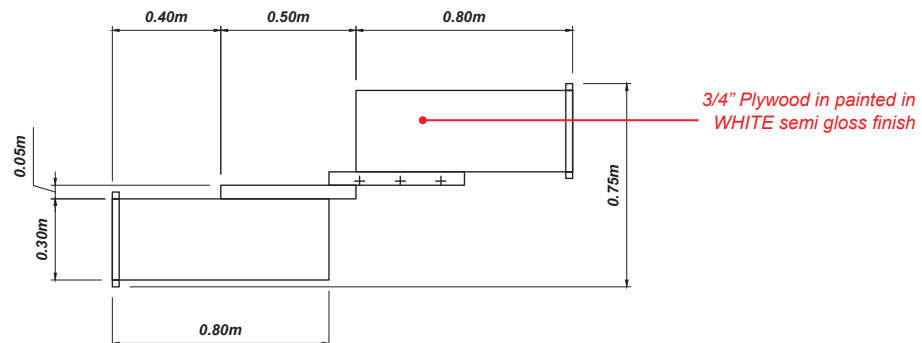

WOODEN PANEL
3/4" Plywood in 2" x 2" KD framing painted in **Pantone 548 U Solid Uncoated**

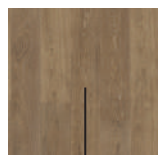
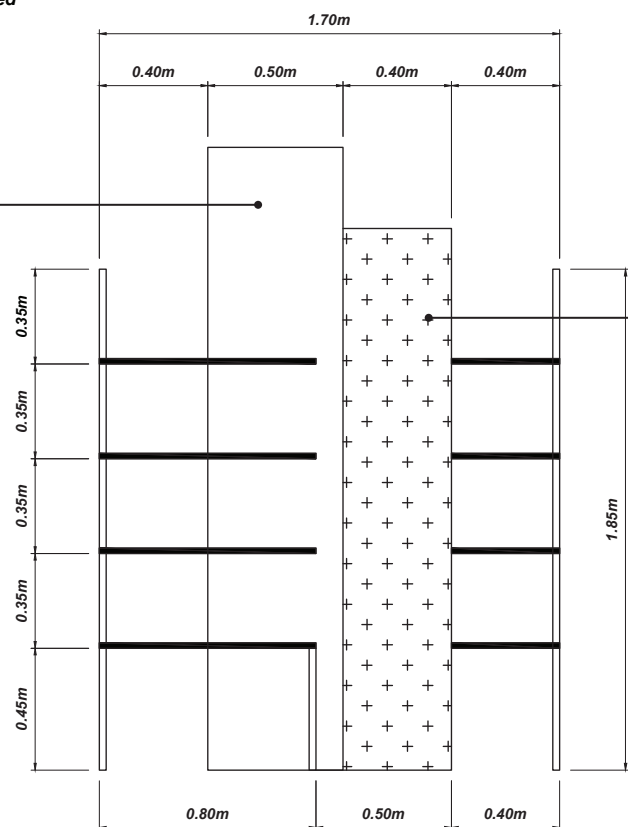

WOODEN PANEL
3/4" Plywood in 2" x 2" KD framing painted in **DARK OAK WOOD**

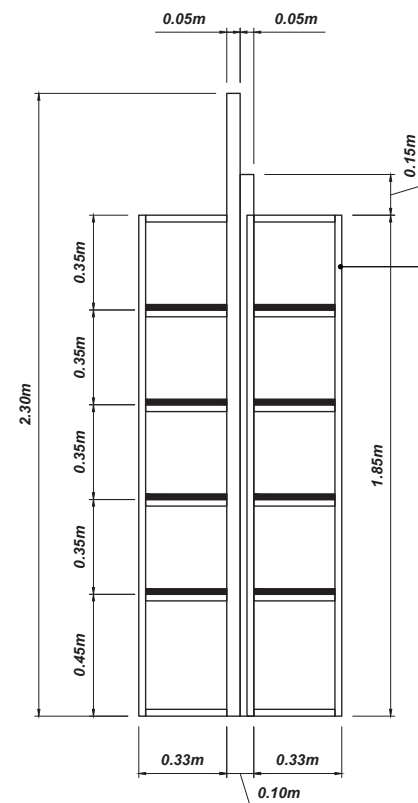

1" X 1" 1.5MM THK Square Hollow Metal painted in **Pantone 2313 U Solid Uncoated**



**GONDOLA DISPLAY
5 UNITS**

 CDEM EXHIBITION AND DESIGN DIVISION	PROJECT:	GULFOOD 2022	CONTENT:	DETAILS	
	TITLE:	PHILIPPINE PAVILION	DESIGNER:	MIR	
DATE:	01/07/2022	REVISION:	01	LOCATION:	DUBAI WORLD TRADE CENTER
			SHEET NO.:	14	

**PRODUCT SHOWCASE (CLUSTER A)
ELEVATION VIEW**



**PRODUCT SHOWCASE
8 UNITS**

WOODEN SHELF
3/4" Plywood
DARK OAK WOOD

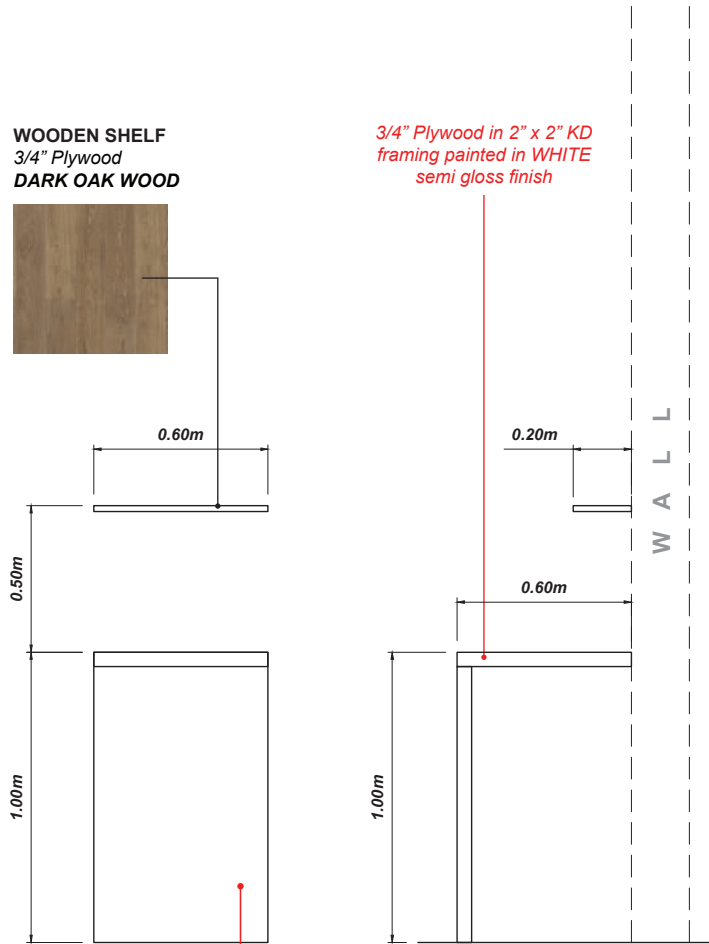

3/4" Plywood in 2" x 2" KD
framing painted in WHITE
semi gloss finish

3/4" Plywood in 2" x 2" KD
framing painted in WHITE
semi gloss finish

3/4" Plywood in painted in
WHITE semi gloss finish

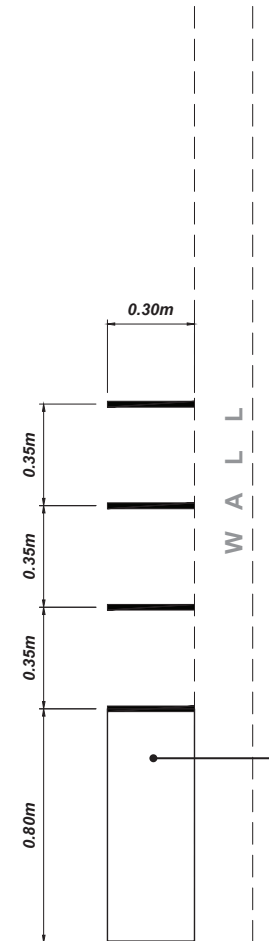
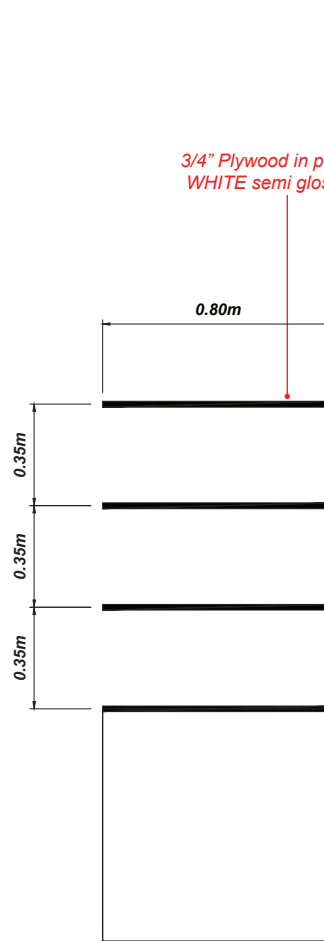

3/4" Plywood Painted in
Pantone 5757U Solid
Uncoated in EGGSHELL
Texture



	PROJECT:	GULFOOD 2022	CONTENT:	DETAILS			
	TITLE:	PHILIPPINE PAVILION	DESIGNER:	MIR			
DATE:	01/07/2022	REVISION:	01	LOCATION:	DUBAI WORLD TRADE CENTER	SHEET NO.:	15

**EMB / PCA (CLUSTER B)
ELEVATION VIEW**

WOODEN STURCTURE
3/4" Plywood in 2" x 2" KD
framing painted in **Pantone**
5757U Solid Uncoated in
EGGSHELL Texture



**GRAPHICS ON
FOAMBOARD**
1.00m x 0.60m

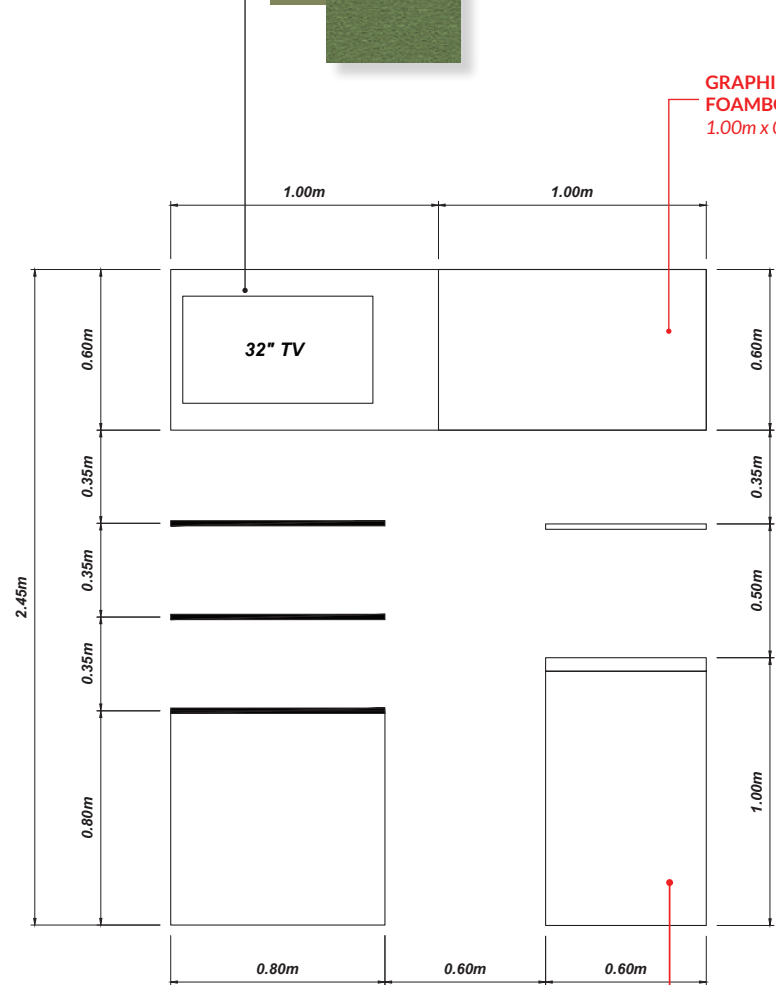

3/4" Plywood in 2" x 2" KD
framing painted in **WHITE**
semi gloss finish

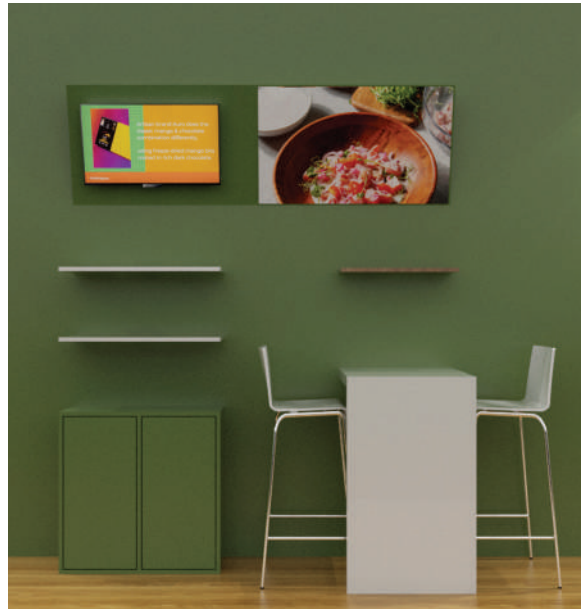
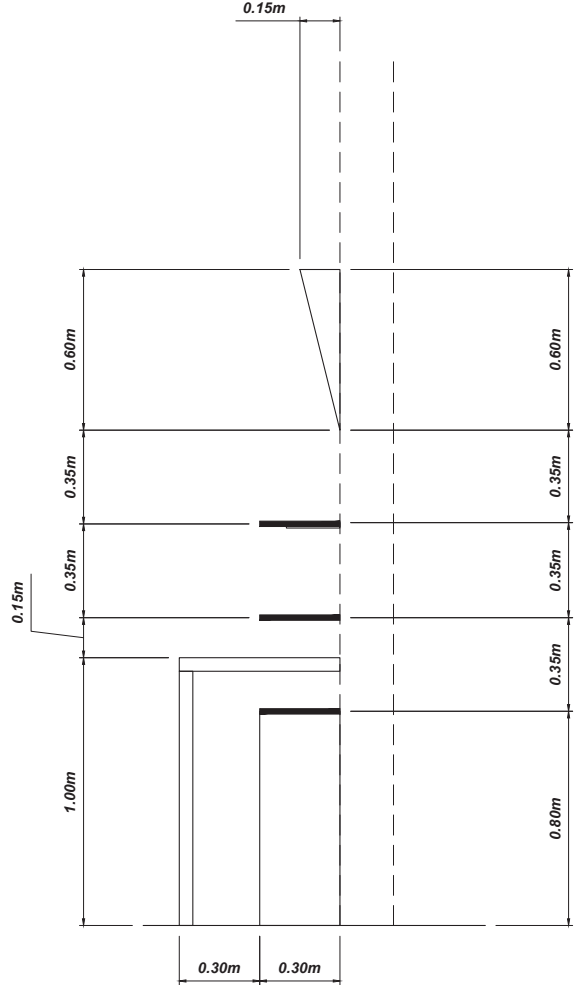

**EMB / PCA
2 SETS**

	PROJECT:	GULFOOD 2022	CONTENT:	DETAILS	
	TITLE:	PHILIPPINE PAVILION	DESIGNER:	MIR	
DATE:	01/07/2022	REVISION:	01	LOCATION:	DUBAI WORLD TRADE CENTER
			SHEET NO.:	16	

**GONDOLA DISPLAY (CLUSTER B)
ELEVATION VIEW**

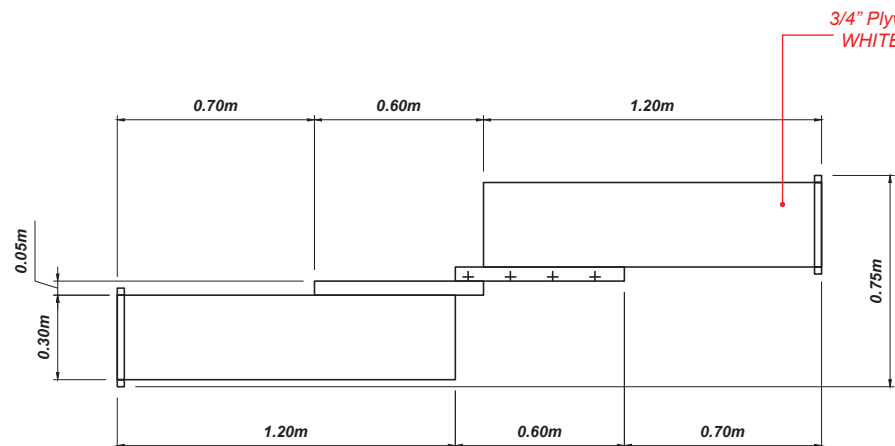

WOODEN PANEL
3/4" Plywood in 2" x 2" KD framing painted in **DARK OAK WOOD**

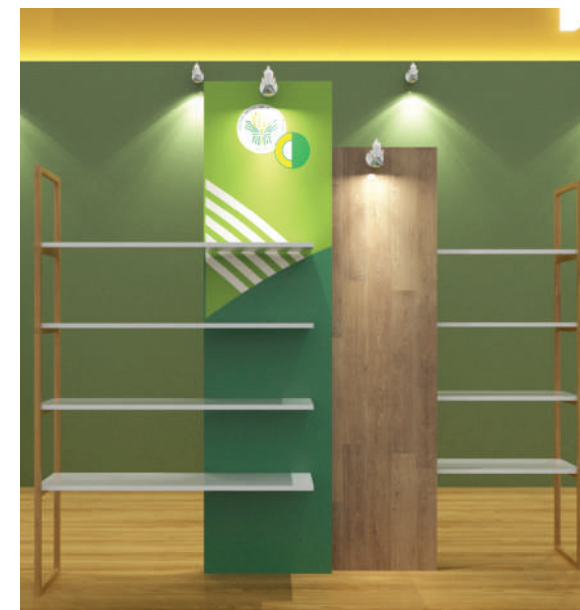

**GONDOLA DISPLAY - B
2 UNITS**

**GRAPHICS ON
FOAMBOARD**
2.30m x 0.60m

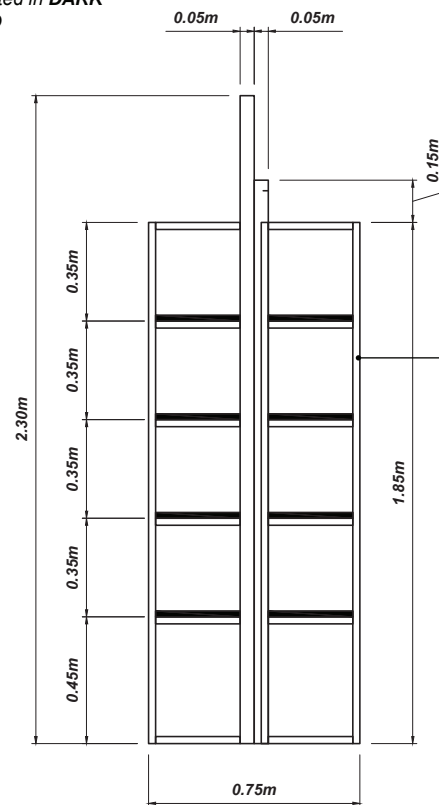
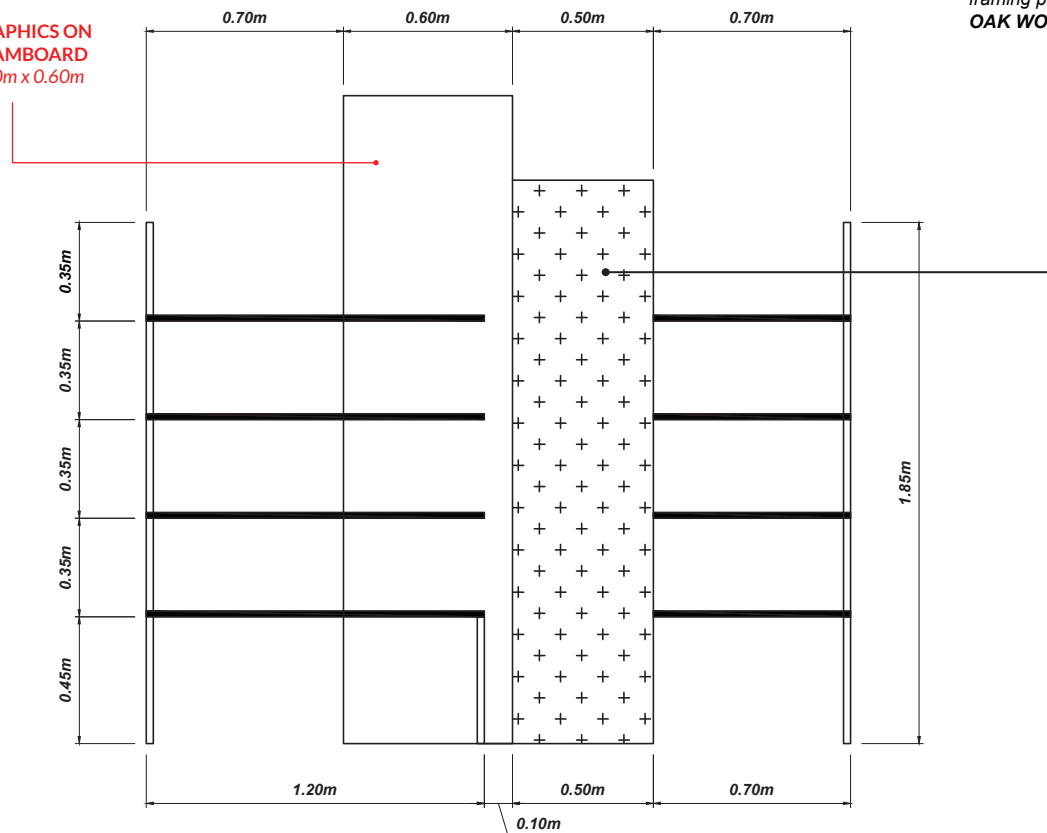

1" X 1" 1.5MM THK Square
Hollow Metal painted in **Pantone 2313 U Solid Uncoated**



	PROJECT:	GULFOOD 2022	CONTENT:	DETAILS	
	TITLE:	PHILIPPINE PAVILION	DESIGNER:	MIR	
DATE:	01/07/2022	REVISION:	01	LOCATION:	DUBAI WORLD TRADE CENTER
			SHEET NO.:	17	

**STORAGE AREA
ELEVATION VIEW**

WOODEN STURCTURE
3/4" Plywood in 2" x 2" KD
framing painted in Pantone
5757U Solid Uncoated in
EGGSHELL Texture

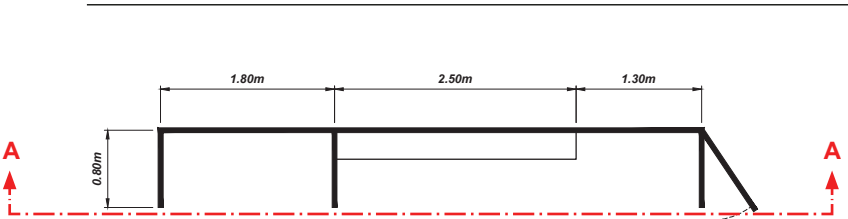
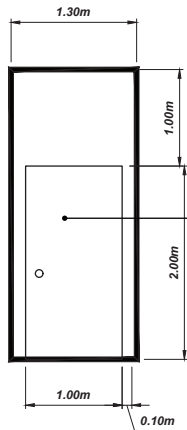
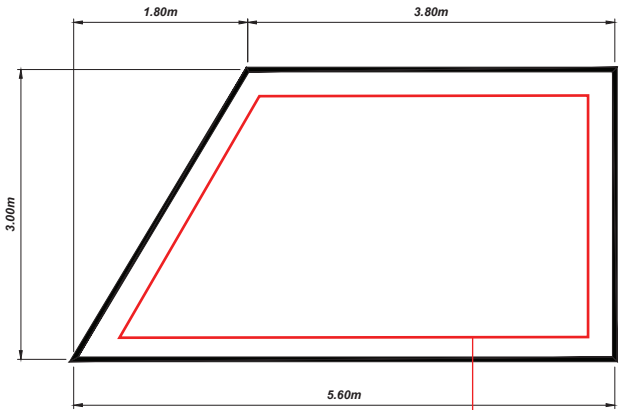
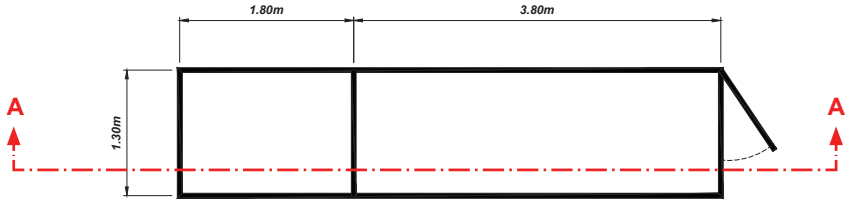
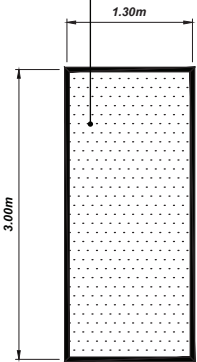

GRAPHICS INSTALLATION
Digital Print Sticker
3.00m x 5.60m

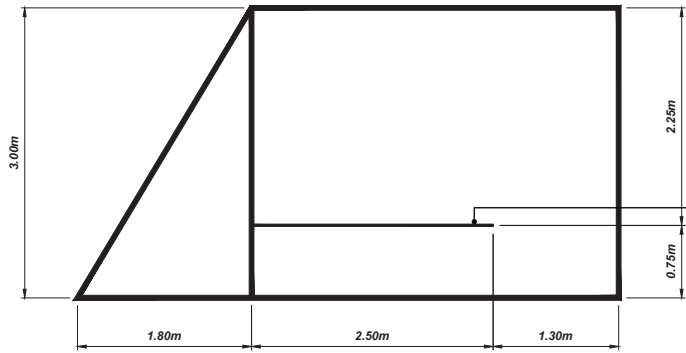

3/4 PLYWOOD LEDGE
in WHITE semi gloss finish

SECTION A-A

	PROJECT:	GULFOOD 2022	CONTENT:	DETAILS	
	TITLE:	PHILIPPINE PAVILION	DESIGNER:	MIR	
DATE:	01/07/2022	REVISION:	01	LOCATION:	DUBAI WORLD TRADE CENTER
			SHEET NO.:	18	

**LED WALL
1 UNIT**

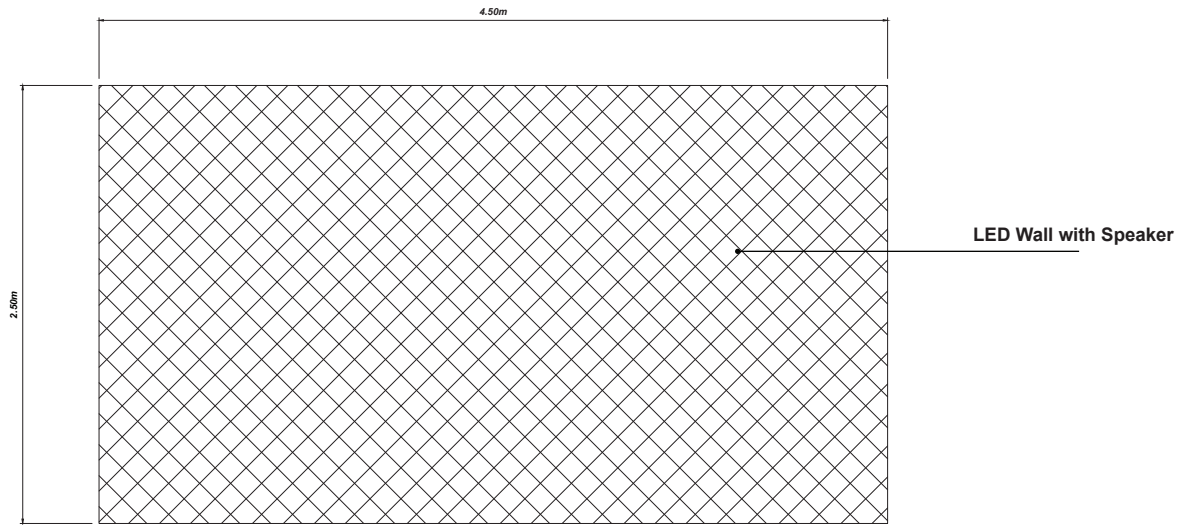

**QR CODE STAND
50 UNITS**

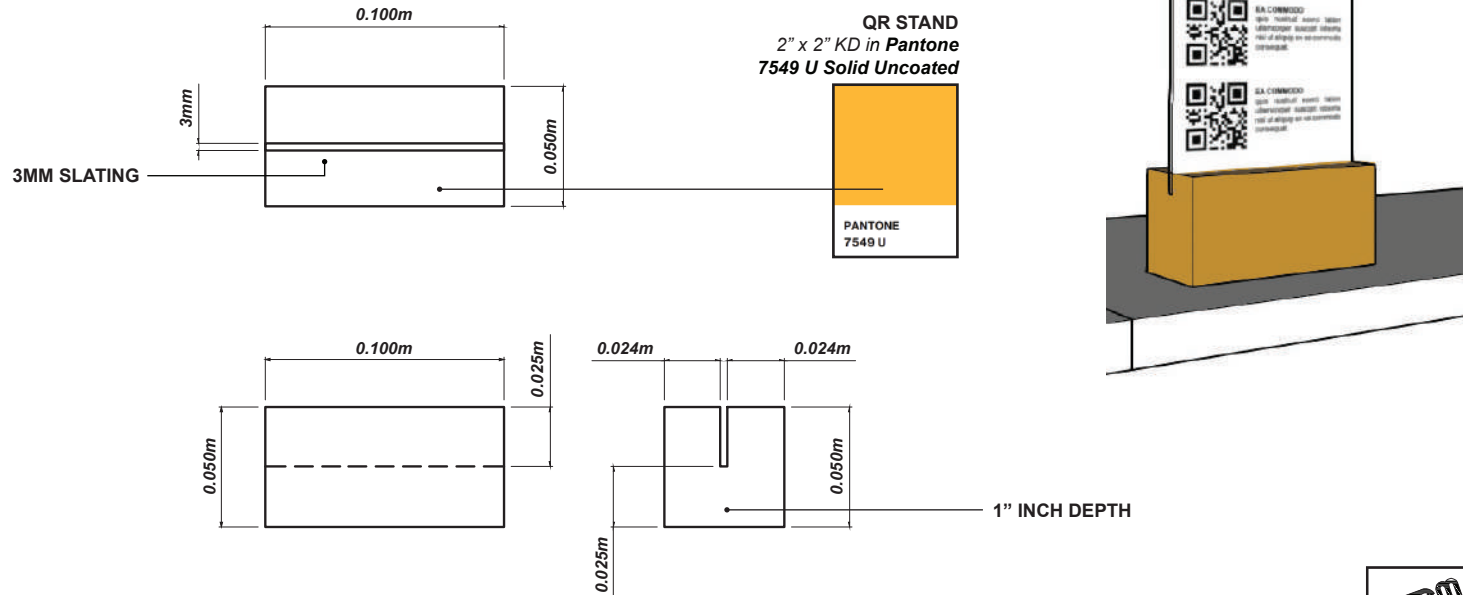



 EXHIBITION AND DESIGN DIVISION	PROJECT:	GULFOOD 2022	CONTENT:	DETAILS	
	TITLE:	PHILIPPINE PAVILION	DESIGNER:	MIR	
DATE:	01/07/2022	REVISION:	01	LOCATION:	DUBAI WORLD TRADE CENTER
			SHEET NO.:	19	

**LIGHTING
CLUSTER A**

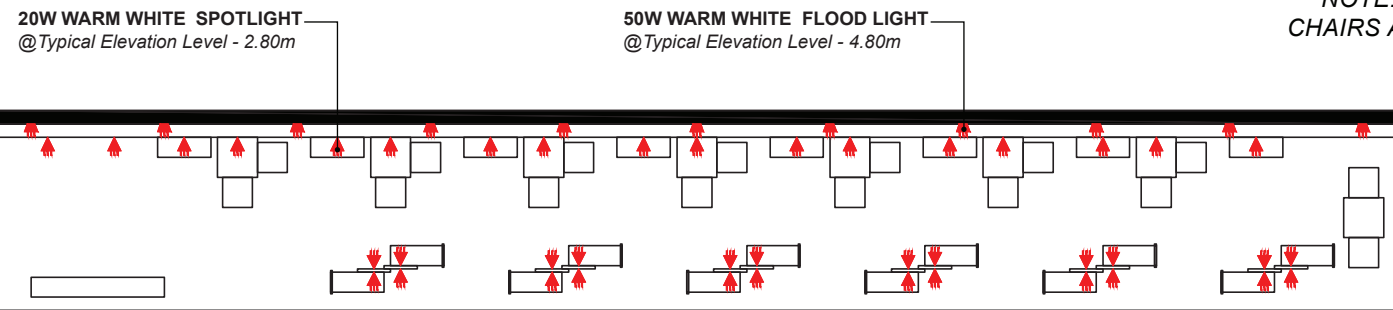
NOTE: SHELVES, GONDOLA, TABLE & CHAIRS ARE NOT SHOWN FOR CLARITY



-  18 UNITS
50W WARM WHITE
FLOOD LIGHT
-  46 UNITS
20W WARM WHITE
SPOT LIGHT

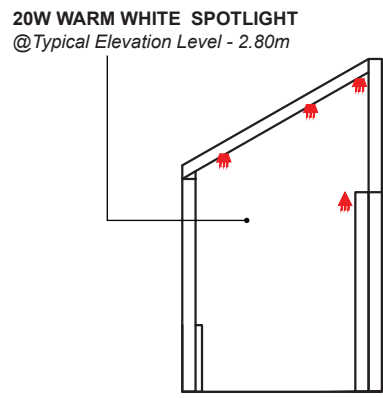
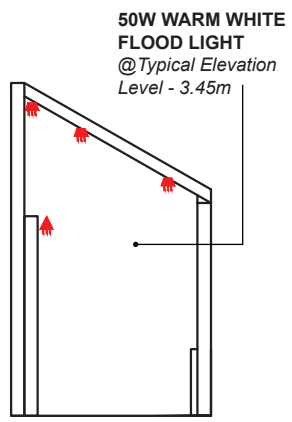
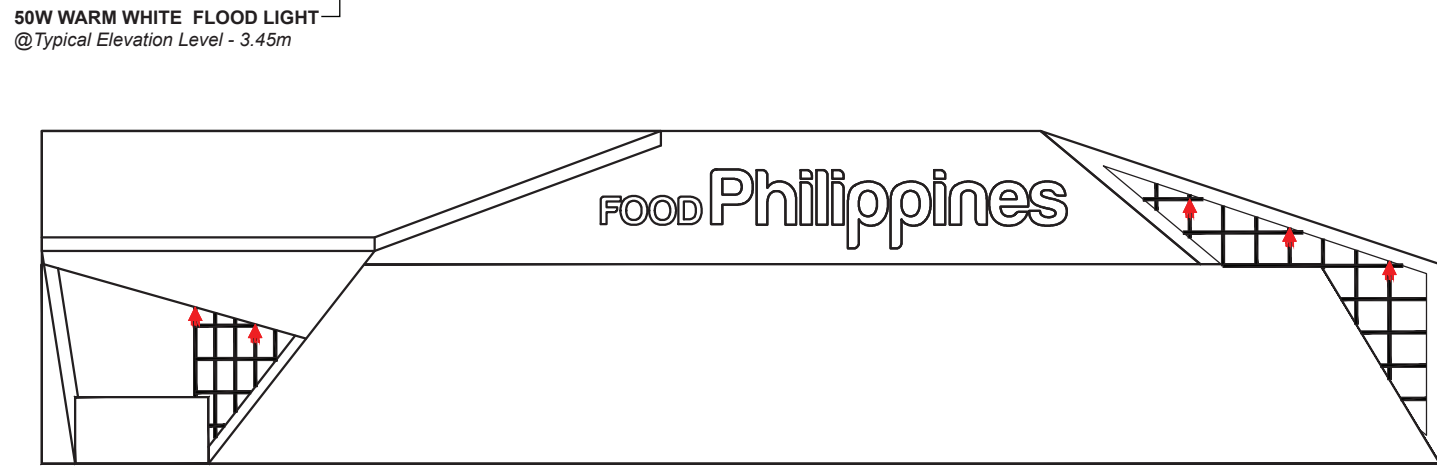
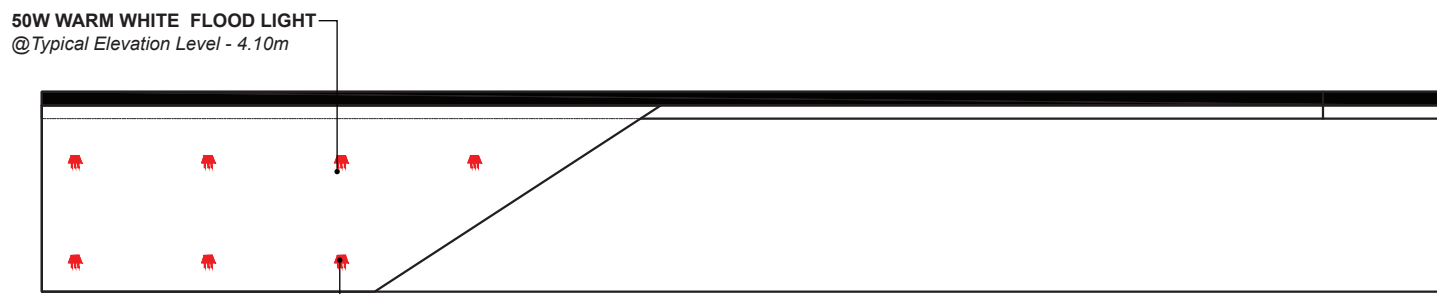

	PROJECT:	GULFOOD 2022	CONTENT:	DETAILS	
	TITLE:	PHILIPPINE PAVILION	DESIGNER:	MIR	
DATE:	01/07/2022	REVISION:	01	LOCATION:	DUBAI WORLD TRADE CENTER
			SHEET NO.:	21	

**LIGHTING
CLUSTER B**

NOTE: SHELVES, GONDOLA, TABLE & CHAIRS ARE NOT SHOWN FOR CLARITY

20W WARM WHITE SPOTLIGHT
@Typical Elevation Level - 2.80m

50W WARM WHITE FLOOD LIGHT
@Typical Elevation Level - 4.60m

16 UNITS
50W WARM WHITE
FLOOD LIGHT

27 UNITS
20W WARM WHITE
SPOT LIGHT

1 UNIT
FLOURECENT LIGHT

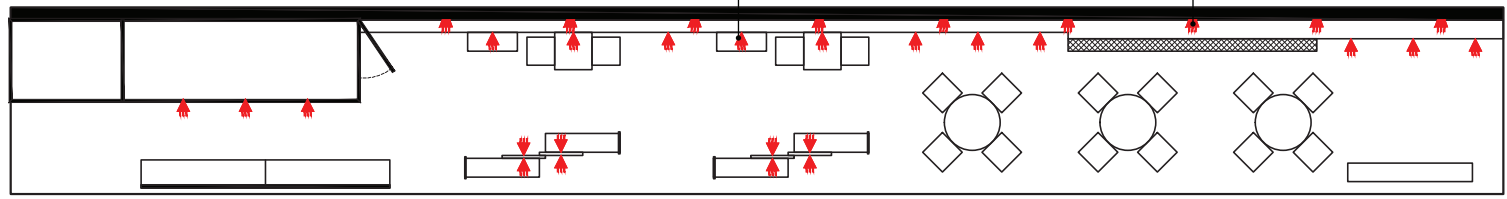

50W WARM WHITE FLOOD LIGHT
@Typical Elevation Level - 4.10m

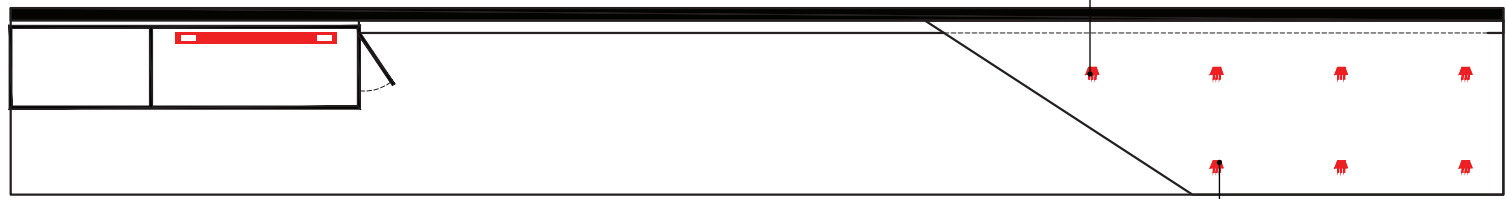

50W WARM WHITE FLOOD LIGHT
@Typical Elevation Level - 3.45m

50W WARM WHITE FLOOD LIGHT
@Typical Elevation Level - 4.10m

50W WARM WHITE FLOOD LIGHT
@Typical Elevation Level - 3.45m

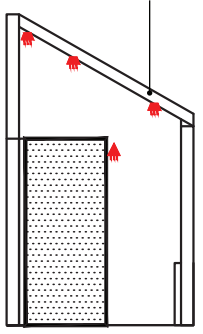

FOOD Philippines



20W WARM WHITE SPOTLIGHT
@Typical Elevation Level - 2.80m

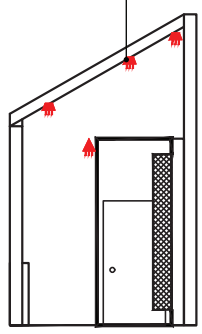

	PROJECT:	GULFOOD 2022	CONTENT:	DETAILS	
	TITLE:	PHILIPPINE PAVILION	DESIGNER:	MIR	
DATE:	01/07/2022	REVISION:	01	LOCATION:	DUBAI WORLD TRADE CENTER
				SHEET NO.:	22

OUTLETS AND BREAKERS

CLUSTER A & B

NOTE: SHELVES, GONDOLA, TABLE & CHAIRS ARE NOT SHOWN FOR CLARITY

CLUSTER A

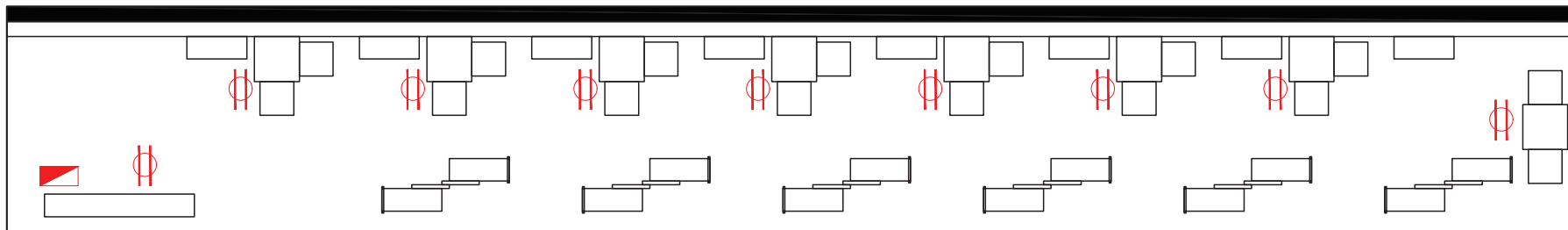

3 UNITS
CIRCUIT BREAKER - CONTRACTOR
TO PROVIDE RATING



18 UNITS
3 GANG CONVENIENCE
OUTLET

CLUSTER B

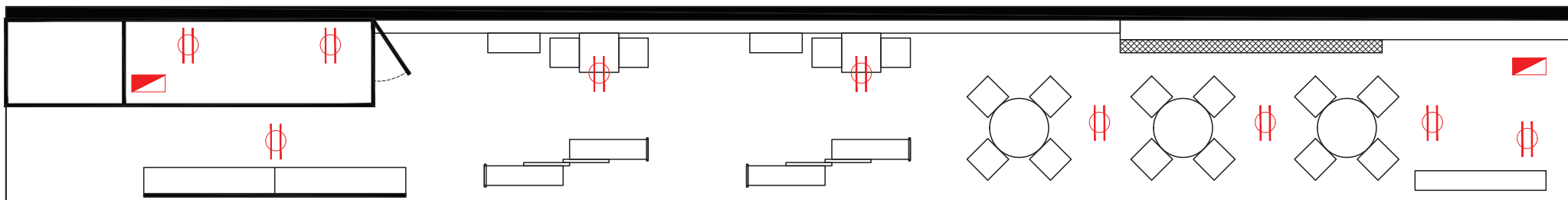

	PROJECT:	GULFOOD 2022	CONTENT:	DETAILS	
	TITLE:	PHILIPPINE PAVILION	DESIGNER:	MIR	
DATE:	01/07/2022	REVISION:	01	LOCATION:	DUBAI WORLD TRADE CENTER
				SHEET NO.:	23